

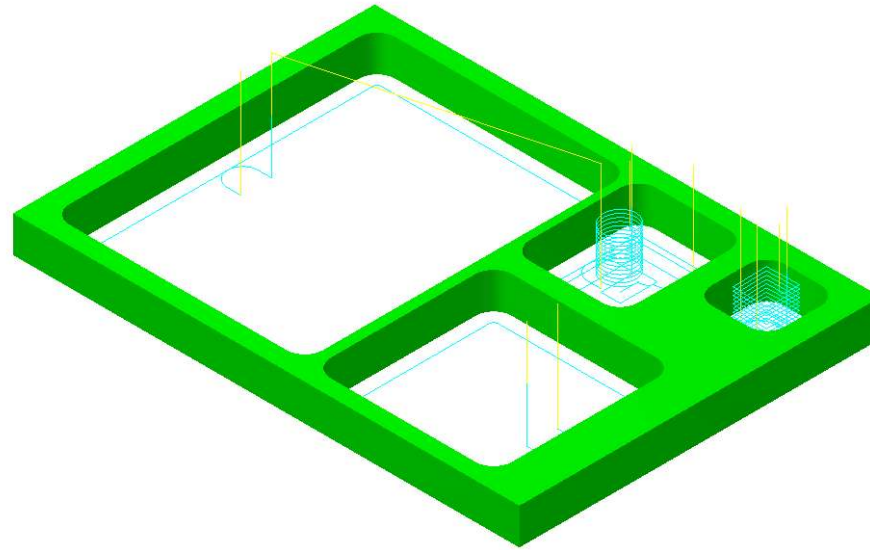

SETUP SHEET

SPECIFICATIONS

PROJECT:	ABC Test Project
CUSTOMER:	ABC Manufacturing Company
PROGRAMMER:	John Barker
DRAWING #:	12345



Gview:ISO WCS:TOP T/Cplane:TOP

0.9039
Inch

ROUTING: 87-654-32
CNC FOREMAN:
OPERATOR 1:
OPERATOR 2:

DEPARTMENT: MILL
PLANT:
SECTION:
LOCATION:



SETUP SHEET

SPECIFICATIONS	
PROJECT:	ABC Test Project
CUSTOMER:	ABC Manufacturing Company
PROGRAMMER:	John Barker
DRAWING #:	12345

Contour (2D), op_idn #2

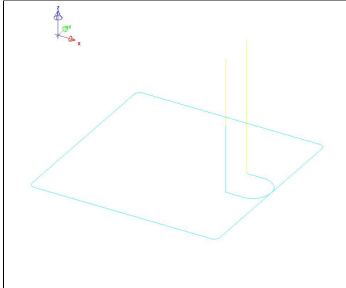

#237:1 - 0.3750 ENDMILL1 FLAT - 3/8 FLAT ENDMILL

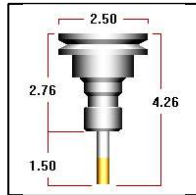

HOLDER:	C4C4-0016	LIBRARY:	CT40
TOOL OFFSETS:	237 (D)	237 (L)	
DIAMETER:	0.375	FPT:	0.0011
FLUTES:	4	SFM:	139.9869
LENGTH:	1.5	CORNER RAD:	0.0

SPINDLE SPD:	1426 RPM
FEEDRATE:	6.332 inch/min
CYCLE TIME:	00:01:36
WORK OFFSET:	0

COMMENTS:

2.5 x 2.5 Pocket. Install clamps

EST CYCLE TIME: 00:01:36 ACTUAL TIME:

2D High Speed (2D Area Mill), op_idn #3

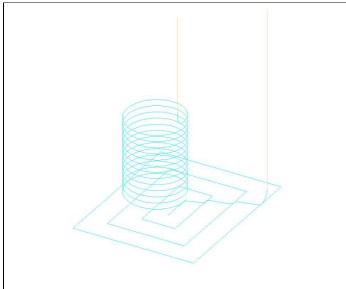

#239:6 - 0.5000 ENDMILL1 FLAT - 1/2 FLAT ENDMILL

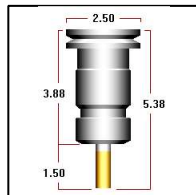

HOLDER:	C4C4-0032	LIBRARY:	CT40
TOOL OFFSETS:	239 (D)	239 (L)	
DIAMETER:	0.5	FPT:	0.0015
FLUTES:	4	SFM:	139.9215
LENGTH:	1.5	CORNER RAD:	0.0

SPINDLE SPD:	1069 RPM
FEEDRATE:	6.4176 inch/min
CYCLE TIME:	00:04:27
WORK OFFSET:	0

COMMENTS:

1.5 x 1.75 Pocket

EST CYCLE TIME: 00:04:27 ACTUAL TIME:



SETUP SHEET

SPECIFICATIONS	
PROJECT:	ABC Test Project
CUSTOMER:	ABC Manufacturing Company
PROGRAMMER:	John Barker
DRAWING #:	12345

Pocket (Standard), op_idn #5

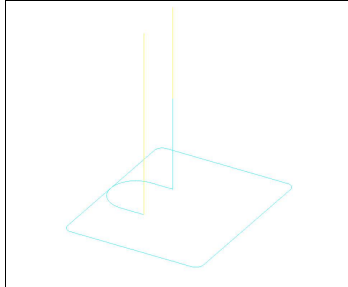

#237:1 - 0.3750 ENDMILL1 FLAT - 3/8 FLAT ENDMILL

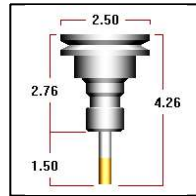

SPINDLE SPD:	1426 RPM
FEEDRATE:	6.332 inch/min
CYCLE TIME:	00:01:03
WORK OFFSET:	0

HOLDER:	C4C4-0016	LIBRARY:	CT40
TOOL OFFSETS:	237 (D)	237 (L)	
DIAMETER:	0.375	FPT:	0.0011
FLUTES:	4	SFM:	139.9869
LENGTH:	1.5	CORNER RAD:	0.0

COMMENTS:	
<i>1.5 x 1.75 Pocket</i>	
EST CYCLE TIME:	00:01:03
ACTUAL TIME:	

Contour (2D), op_idn #6

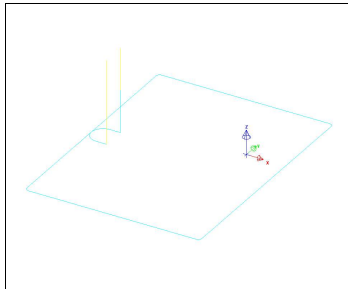

#237:1 - 0.3750 ENDMILL1 FLAT - 3/8 FLAT ENDMILL

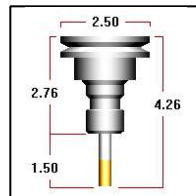

SPINDLE SPD:	1426 RPM
FEEDRATE:	6.332 inch/min
CYCLE TIME:	00:02:33
WORK OFFSET:	0

HOLDER:	C4C4-0016	LIBRARY:	CT40
TOOL OFFSETS:	237 (D)	237 (L)	
DIAMETER:	0.375	FPT:	0.0011
FLUTES:	4	SFM:	139.9869
LENGTH:	1.5	CORNER RAD:	0.0

COMMENTS:	
<i>3.5 x 4.5 Pocket</i>	
EST CYCLE TIME:	00:02:33
ACTUAL TIME:	



SETUP SHEET

SPECIFICATIONS

PROJECT:	ABC Test Project
CUSTOMER:	ABC Manufacturing Company
PROGRAMMER:	John Barker
DRAWING #:	12345

TOOL LIST

#	Type	Diameter	Tool Name	SORTED: NO	
				Cor. rad.	Rad. Type
237	Endmill1 Flat	0.375	3/8 FLAT ENDMILL	0.0	None
239	Endmill1 Flat	0.5	1/2 FLAT ENDMILL	0.0	None



SETUP SHEET

SPECIFICATIONS

PROJECT:	ABC Test Project
CUSTOMER:	ABC Manufacturing Company
PROGRAMMER:	John Barker
DRAWING #:	12345

IMAGE LIST

CAPTURE #1

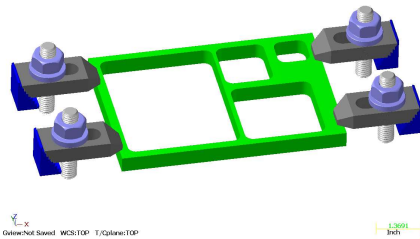

CAPTURE #3

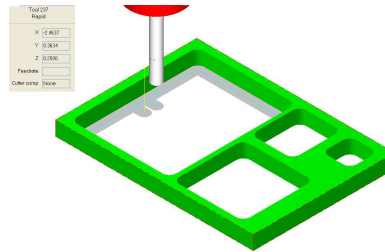

CAPTURE #5

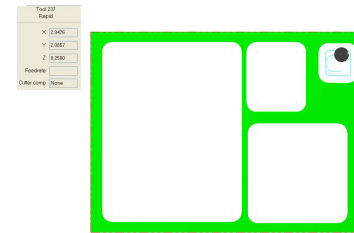

CAPTURE #2

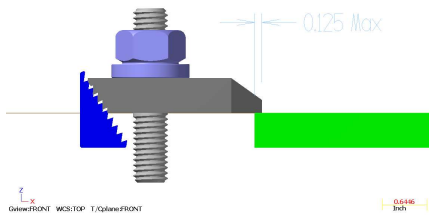

CAPTURE #4

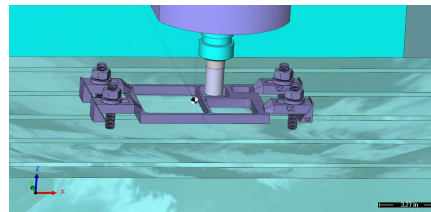

CAPTURE #6

